

## AGENDA BILL APPROVAL FORM

<b>Agenda Subject</b> Consultant Agreement AG-C-318		<b>Date:</b> December 10, 2007
<b>Department:</b> Public Works	<b>Attachments:</b> Budget Status Sheet, Vicinity Map	<b>Budget Impact:</b> \$ 0
<b>Administrative Recommendation:</b>  City Council to grant permission to enter into Consultant Agreement No. AG-C-318 with Hedges Engineering and Consulting, Inc. for Engineering Services on Project No. CP0703 – Lakehaven Watermain Design.		
<b>Background Summary</b>  The interlocal agreement establishing water service boundaries between the City and the Lakehaven Utility District (authorized by resolution 3652 and executed in February 2004) obligated the City to provide Lakehaven with the design and any required permanent easements for a new waterline. The new waterline will be approximately 2200 ft long and will complete a loop that eliminates a dead-end line and an outdated pump station. The line will be constructed and owned by Lakehaven.  City staff has already completed the easement acquisition process and has selected Hedges Engineering and Consulting, Inc. to provide engineering services for the Lakehaven waterline design at a cost not to exceed \$94,000.  Consultant work will include topographic survey, geotechnical investigation, design and preparation of plans and specifications, and coordination with Lakehaven and the City.  It is expected that a project budget increase of \$35,000 within the 430 Fund will be necessary; however, it will not require a budget adjustment because available funds from the 430 Fund - Improvements budget will be utilized.  W1217-3 O4.11.1 CP0703		
<b>Reviewed by Council &amp; Committees:</b> <input type="checkbox"/> Arts Commission <input type="checkbox"/> Airport <input type="checkbox"/> Hearing Examiner <input type="checkbox"/> Human Services <input type="checkbox"/> Park Board <input type="checkbox"/> Planning Comm. <b>COUNCIL COMMITTEES:</b> <input type="checkbox"/> Finance <input type="checkbox"/> Municipal Serv. <input type="checkbox"/> Planning & CD <input checked="" type="checkbox"/> Public Works <input type="checkbox"/> Other _____		<b>Reviewed by Departments &amp; Divisions:</b> <input type="checkbox"/> Building <input type="checkbox"/> Cemetery <input type="checkbox"/> Finance <input type="checkbox"/> Fire <input type="checkbox"/> Human Resources <input type="checkbox"/> Legal <input type="checkbox"/> M&O <input type="checkbox"/> Mayor <input type="checkbox"/> Parks <input type="checkbox"/> Planning <input type="checkbox"/> Police <input checked="" type="checkbox"/> Public Works
<b>Action:</b> Committee Approval: <input type="checkbox"/> Yes <input type="checkbox"/> No Council Approval: <input type="checkbox"/> Yes <input type="checkbox"/> No                    Call for Public Hearing    ___/___/___ Referred to _____ Until ___/___/___ Tabled _____ Until ___/___/___		
<b>Councilmember:</b> Wagner		<b>Staff:</b> Dowdy
<b>Meeting Date:</b> December 17, 2007		<b>Item Number:</b> V.C.5

## BUDGET STATUS SHEET

<b>Project No:</b> CP0703	<b>Project Title:</b> Lakehaven Watermain Design
---------------------------	--

**Project Manager:** Jacob Sweeting

Initiation Date: 02/02/04  
 Advertisement Date: \_\_\_\_\_  
 Award Date: \_\_\_\_\_

- Project Initiation
- Right of Way/Easement Acquisition
- Consultant Contract Award
- Change Order Approval
- Contract Final Acceptance

Date: November 26, 2007

The "Future Years" column indicates the projected amount to be requested in future budgets.

### Funds Budgeted (Funds Available)

Funding	Prior Years	2007	2008	Future Years	Total
430 Fund - Water		100,000			100,000
<b>Total</b>	0	100,000	0	0	100,000

### Estimated Cost (Funds Needed)

Activity	Prior Years	2007	2008	Future Years	Total
Design Engineering - City Costs		10,000	5,000		15,000
Design Engineering - Consultant Fees			94,000		94,000
Easement Acquisition		21,000			21,000
Project Contingency (5%)			5,000		5,000
<b>Total</b>	0	31,000	104,000	0	135,000

### 430 Water Budget Status

	Prior Years	2007	2008	Future Years	Total
*430 Funds Budgeted ( )	0	(100,000)	0	0	(100,000)
430 Funds Needed	0	31,000	104,000	0	135,000
<b>*430 Fund Project Contingency ( )</b>	<b>0</b>	<b>(69,000)</b>	<b>0</b>	<b>0</b>	<b>0</b>
<b>430 Funds Required</b>	<b>0</b>	<b>0</b>	<b>104,000</b>	<b>0</b>	<b>35,000</b>

\* (#) in the Budget Status Sections indicates Money the City has available.

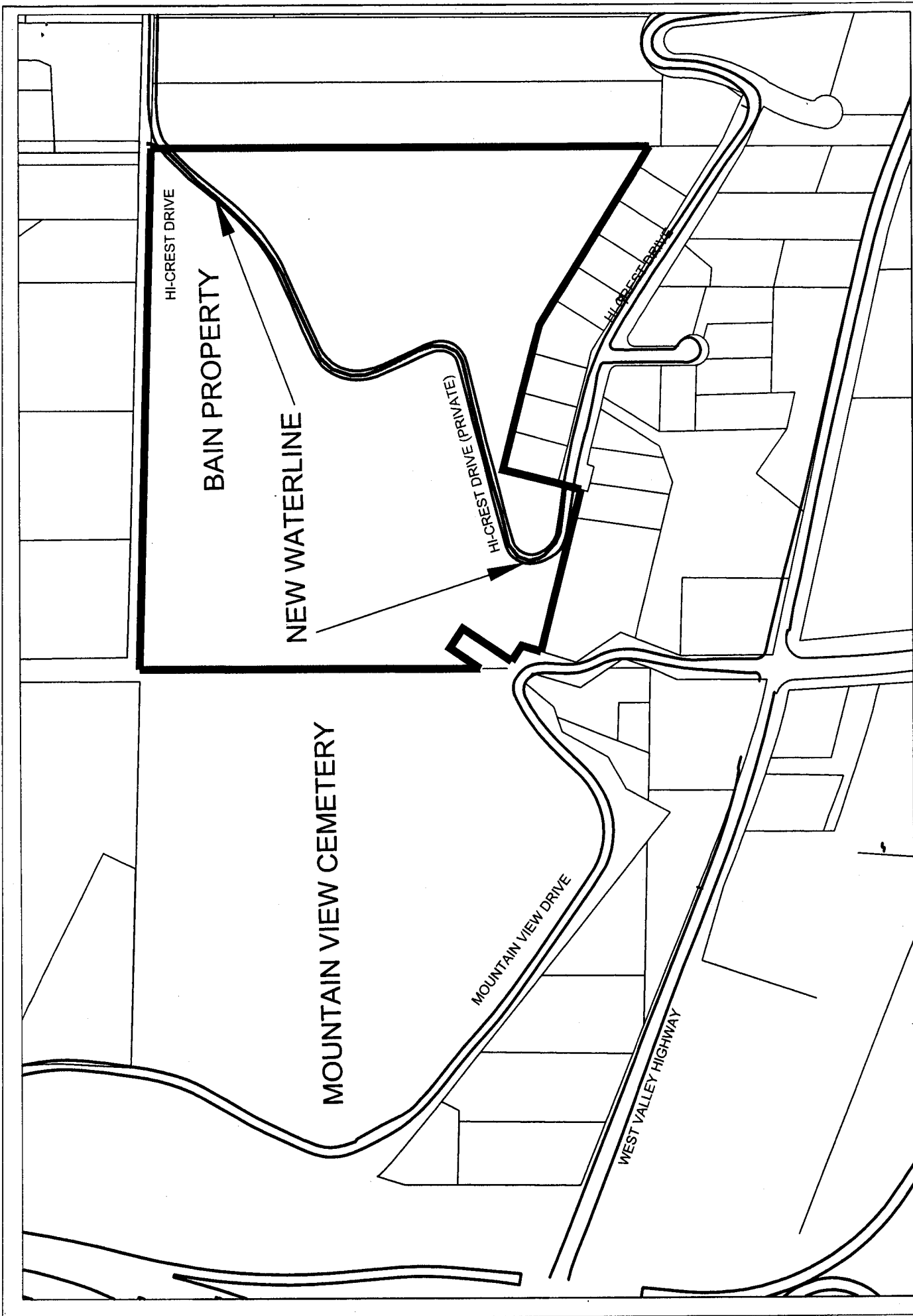

HI-CREST DRIVE

BAIN PROPERTY

NEW WATERLINE

HI-CREST DRIVE (PRIVATE)

HI-CREST DRIVE

MOUNTAIN VIEW CEMETERY

MOUNTAIN VIEW DRIVE

WEST VALLEY HIGHWAY

**CP0703 - Lakehaven Watermain Design  
VICINITY MAP**



PUBLIC WORKS DEPARTMENT  
25 West Main Street  
Auburn, Washington

